



INSTALLATION OF MAGNETIC LOCK



INSTALLATION OF ELECTRIC BOLT



Steps

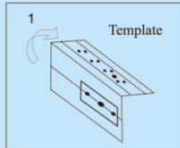

1 Flod the template to 90°

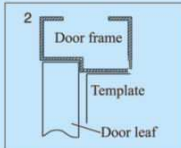

2 Close the door, place the template on door frame, close to door leaf.

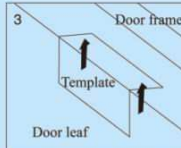

3 Mark screw positions on door leaf and door frame.

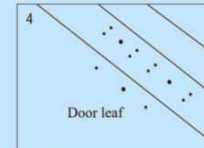

4 Drill holes on the marked positions

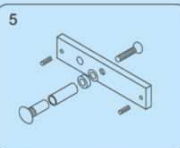

5 Install the Armature Plate on door leaf

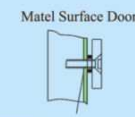
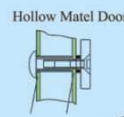

Follow the instructions come with the lock

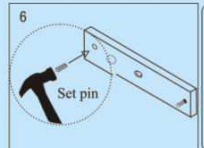

6 Put the pin into the Armature

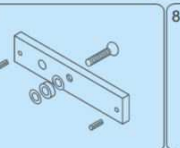

7 according to the picture add the washers on the Armature.

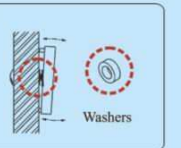

8 Place Washers between Armature Plate and Door Leaf



9 Use Allen Key to remove the Mounting Plate from lock body

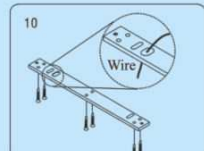

10 Wire go through the wire hole, then screw the mounting plate on top of the door frame

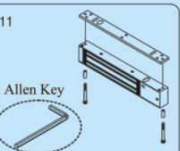

11 Use Allen Key to screw the lock body on the mounting plate

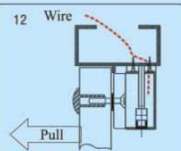

12 Close and pull the door to test holding force, Extra washers can be added to adjust angle between door leaf and Armature plate.

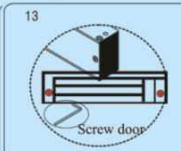

13 Confirm the holding Force and tighten the proof Screws.

Installation of Brackets

Different Brackets can be use on different type and swing direction of door leaf.

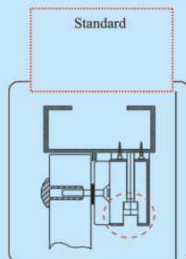

(No Bracket)

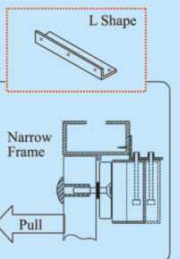

Narrow door frame(Swing Out)

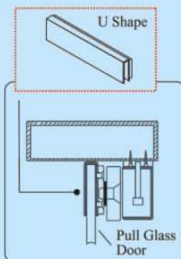

Pull Glass Door Leaf(Swing Out)

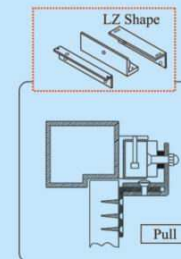

Swing In Installation

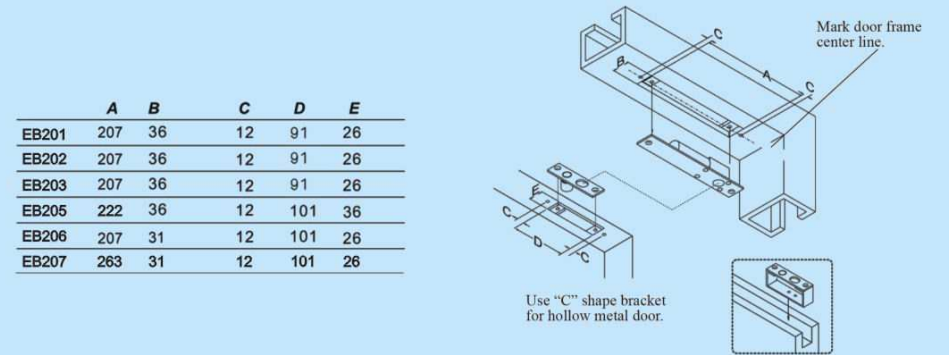

	A	B	C	D	E
EB201	207	36	12	91	26
EB202	207	36	12	91	26
EB203	207	36	12	91	26
EB205	222	36	12	101	36
EB206	207	31	12	101	26
EB207	263	31	12	101	26

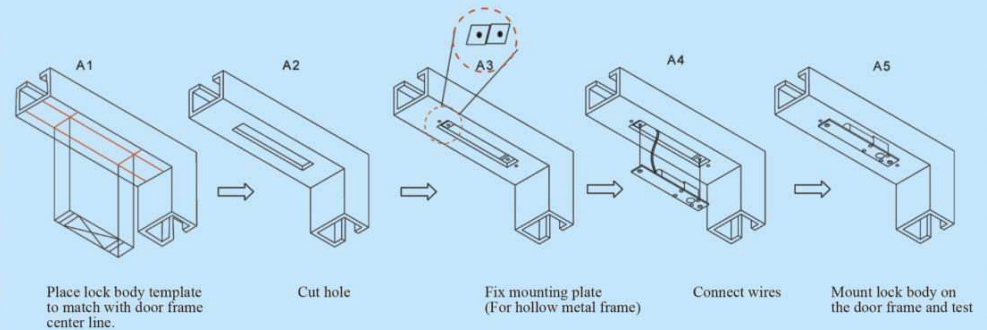

Hollow metal frame
EB201
EB202
EB203
EB205
EB206
EB207



Surface mount for narrow frame and thin door leaf
UBK 919

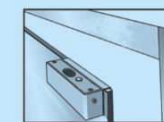

Full glass door leaf
UBK 200



Full glass door leaf and door frame
EG 939U

EG 939U